

User Preferences Configuration

For users who have been assigned a license, it will be possible to access their synchronization preferences and login to their Google account. By entering User Preferences and clicking the Google Calendar Sync Plus menu item, you will be asked to log in to Google by clicking the Connect Google Account button. A window will open that will allow OAuth2 authentication.

The screenshot shows the 'Google Calendar Sync Plus' user preferences configuration page. At the top, there is a header with the title 'Google Calendar Sync Plus' and a 'Stato Connessione' section containing a 'Connetti Account Google' button and a 'Configura' button. Below this is a table titled 'Configurazione servizi web REST' with columns for 'Azioni', 'Nome', 'Access Key', 'Validità', 'Permessi', and 'IP autorizzati'. The table contains two rows: 'default' and 'Prova'. A right-hand sidebar contains a list of menu items under the heading 'INFORMAZIONI', including 'Ruolo e Login Utente', 'Più Informazioni', 'Indirizzo utente', 'Fotografia utente', 'Configurazione Calendario', 'Configurazione Asterisk', 'Configurazione Book me', and 'Sincronizzazione Calendari'. The 'Google Calendar Sync Plus' menu item is highlighted.

Azioni	Nome	Access Key	Validità	Permessi	IP autorizzati
	default	***** Visualizza	Statica	Lettura e scrittura	
	Prova	***** Visualizza	Statica	Lettura e scrittura	

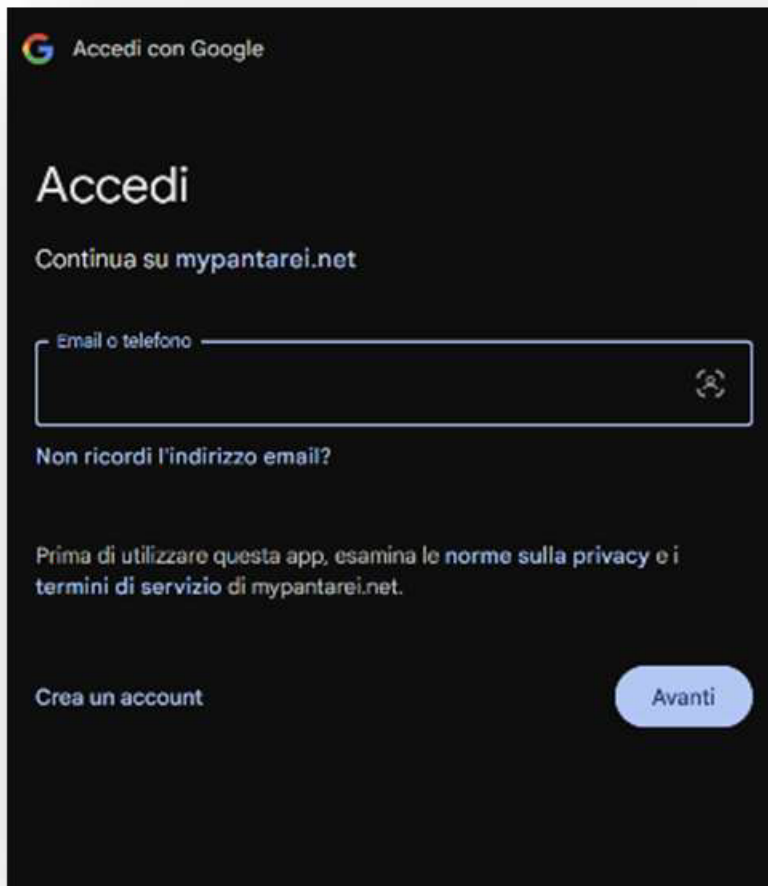

Once logged in, it will be possible to click the “Configure” button to set the preferences.

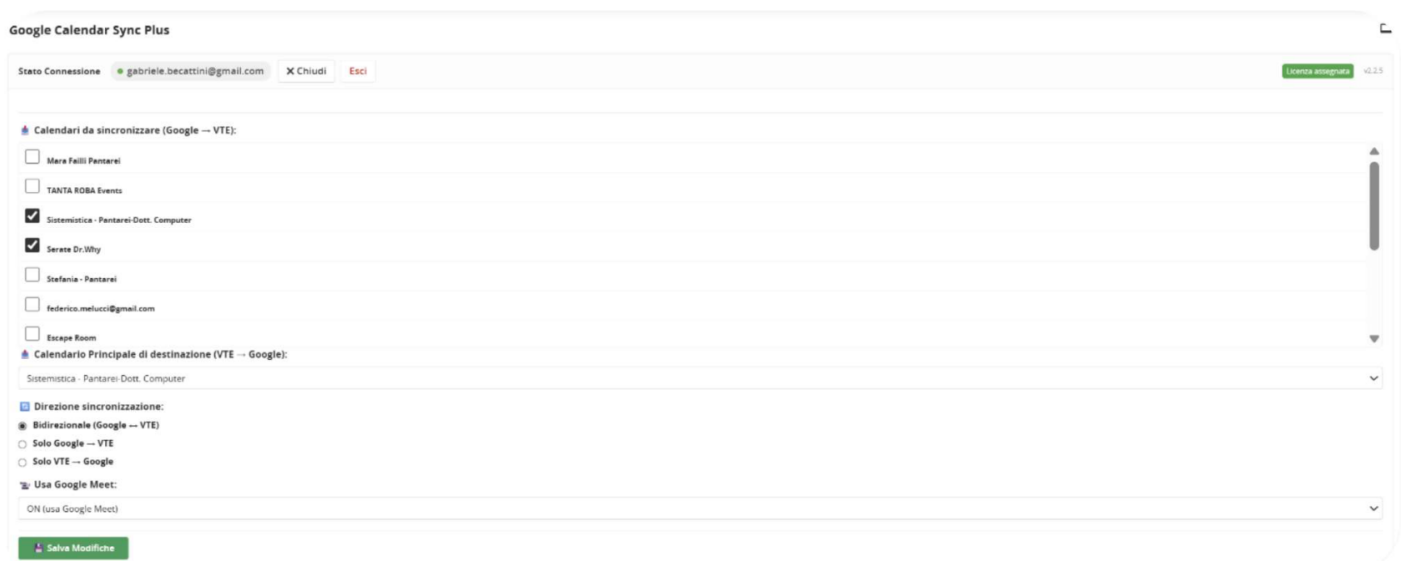

Calendars to Synchronize (Google → VTE)

Select the Calendars that will be reported inside vtenext.

Main Destination Calendar (VTE → Google)

Select the main Google calendar that will be used by default when creating an event in vtenext. (It will be possible to modify it at every event creation by choosing one of those previously selected.)

Synchronization Direction

Set the type of synchronization. The system is designed as bidirectional synchronization, but the user can choose to synchronize unidirectionally from one system to the other.

Use Google Meet

If the admin has enabled the possibility of using the MEET system, the user can choose whether to use it or not from this setting.

Once the settings have been configured and the “Save” button has been pressed, the Plugin is ready to be used.

Revision #4

Created 2026-03-06 14:37:38 UTC by Admin

Updated 2026-03-06 14:44:29 UTC by Admin