

5.2.2 Writing and reading emails

There are three equivalent options to send an email, e.g. to a contact:

1. clicking on the email address shown in the record or in any vtenext page;
2. clicking on the icon in the light blue toolbar, selecting Write

3. from the Messages module interface, clicking on

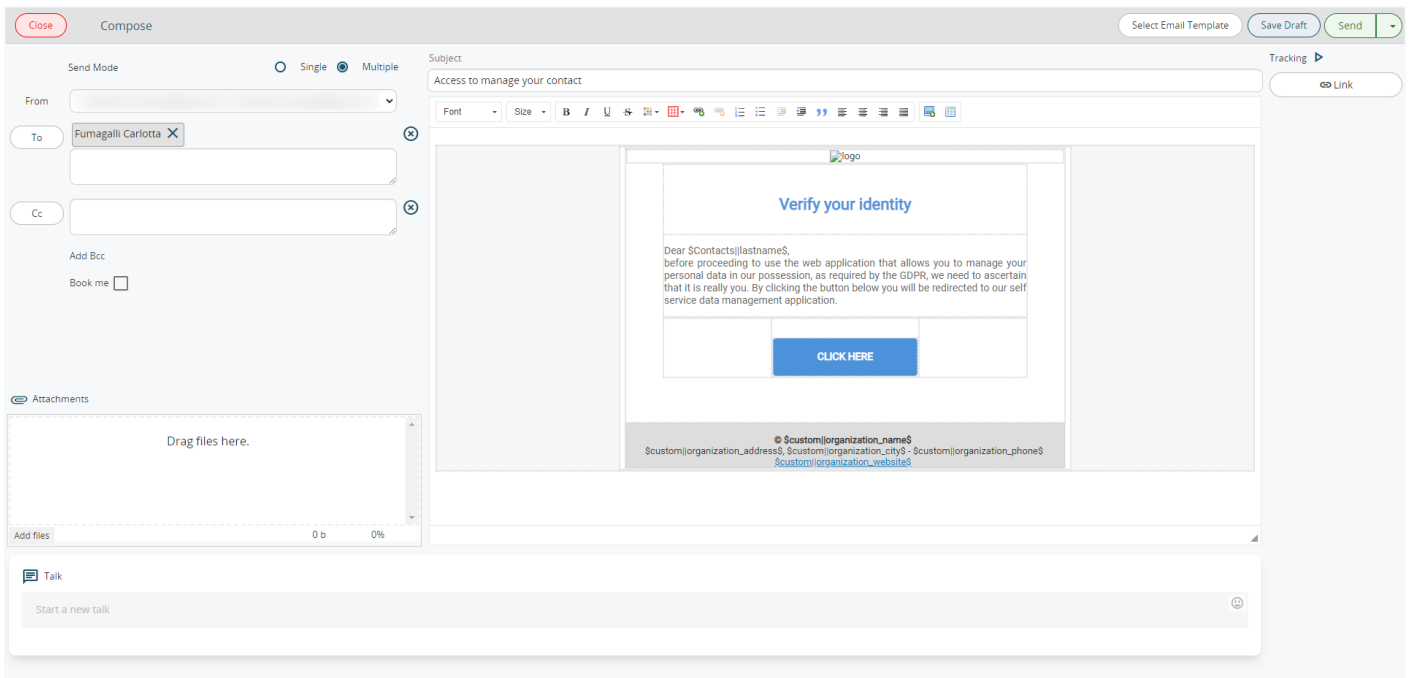

All three options lead to the same New Email page.

To	The recipient email address must be entered; you can write the email address or select it from the list (Leads, Accounts, Contacts, Vendors and Users)
CC	Carbon Copy: you can enter the address of recipients who are to receive a copy of the email
Add BCC	The copy to email addresses added with BCC will not be visible to the other recipients
Subject	The subject of your email

Attachments	You can add attachments to the email by means of the Add file function or by dragging the file to the drop area N.B. when an email is sent from a detail view of a Document (from within the registry, click on the related of the Messages and then click on New Message), any attachments of that email are linked in the Documents related to that same registry
Send method	Single: send a single mail with all visible recipients in the "to" field Multiple: send a separate email to each recipient in the "to" field, without showing the recipients' names or email addresses
Select email Template	Select one of the available templates saved in Settings > Email templates WARNING: When an email template is selected, the Sending Method automatically switches from SINGLE to MULTIPLE.
Send	Sends the email
Save draft	Forces a save of your draft (also occurs automatically)

The account view mask is divided into three parts:

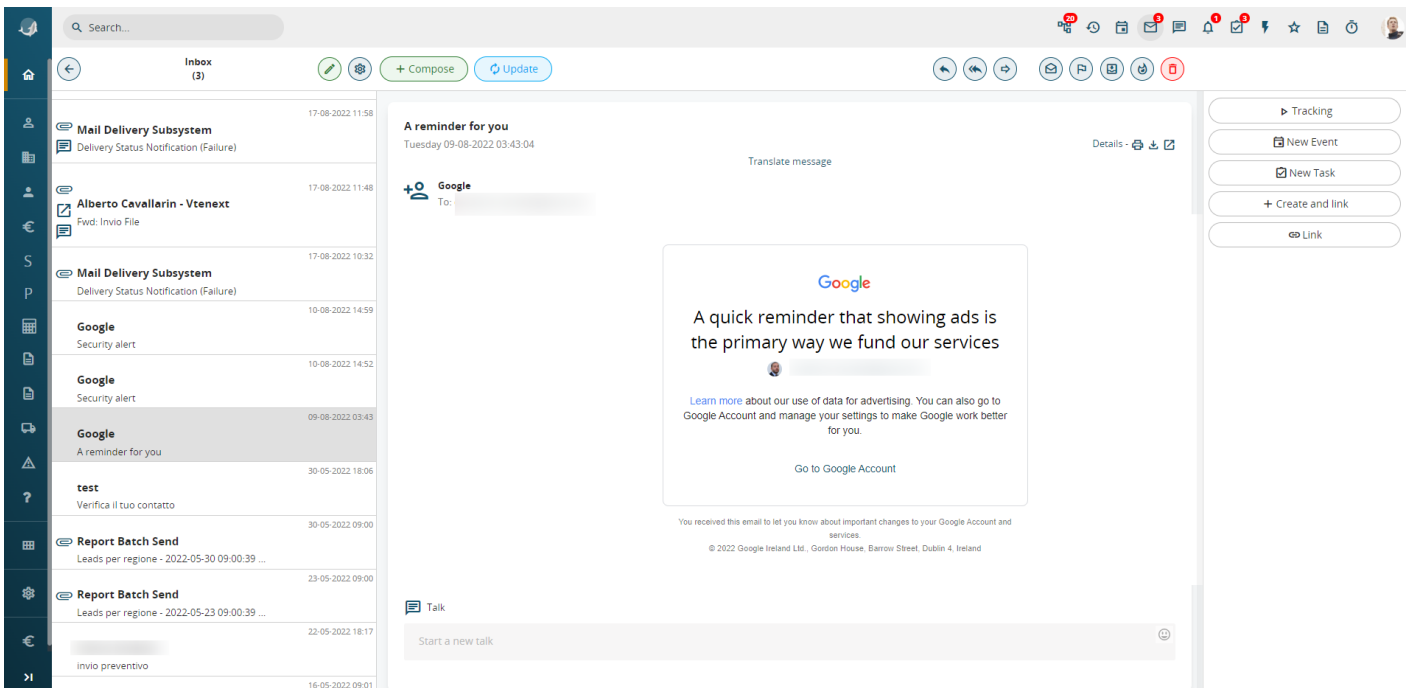

1° column:	2° column:	3° column:
Email list, or	Sender's data	Operations and links available for the email
Folders list by clicking on the Folders button, or	Body of the email	

Accounts list, clicking on the Mailboxes button (shown only if more than one account is configured)	Attachments	
---	-------------	--

N.B.: Starting with the version 20.04 every time a user answers to an email and the recipient's address is not a record in the CRM a new contact is automatically created.

Programmed transmission of an email from the Messages module

From version 19.10, you can program an email to be sent at a later time. In the compose screen, after having entered the subject, the body and the recipient(s), you can click on the arrow located next to the Send button.

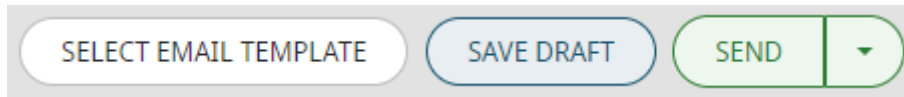

This will open a menu item labelled "Program send".

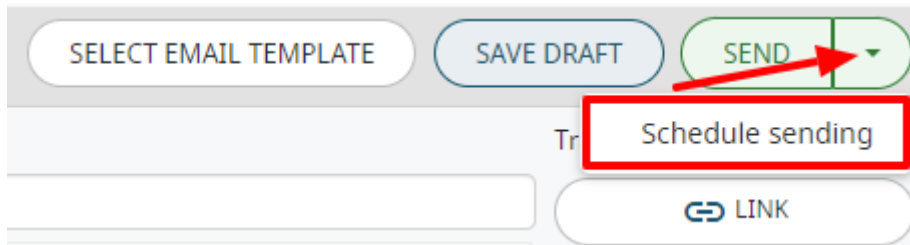

Selecting this option will open a popup with the facility to set the date and time for sending the email in question (choose one of the preset options or click on "other" to configure the exact time and date to send the email).

Schedule sending

Today at 19:00

Tomorrow at 08:00

Tomorrow at 12:00

Tomorrow at 15:00

Other



Choose date and time

22-07-2020 
(dd-mm-yyyy)

18:46 

CANCEL **OK**

Once the email has been programmed, the following functions can be used:

	Send now: send the programmed email immediately
	Scheduled sending: reschedule the previously set sending
	Delete: delete the programmed email permanently

To view the functions mentioned above, simply go to the dedicated folder from the message module ([see chapter 5.2.1](#))

N.B.: Once the sending date and time have been reached, the email will disappear from the scheduled list.

Revision #1

Created 2026-01-28 14:56:13 UTC by Admin

Updated 2026-01-28 14:56:13 UTC by Admin